



City of Gloucester City Council

CITY HALL • GLOUCESTER • MASSACHUSETTS • 01930
Telephone 508-281-9722 Fax 508-281-8472

CITY COUNCIL STANDING COMMITTEE
Planning & Development
May 5, 2010
1st Fl. Council Conference Room – 6:30 p.m.
9 Dale Avenue – City Hall

AGENDA

1. Unfinished Business

- A) CC2010-016 (Verga) Request filed with City Clerk's Office on March 19, 2010 re: Lot on corner of Concord Street and Rt. 128
- B) COM2010-021: Request from Latitude 43 Restaurant & Fisherman's Wharf for temporary extension of use to utilize Lat 43/Fisherman's Wharf adjoining parking lot area for outside Fiesta Family Fish Fry
- C) COM2010-003: Extension of Special Permit re: Cliff Avenue (Continued from 01/13/2010 and from PH2010-005 at City Council under continuance from March 16, 2010)

2. PH2010-002: Installation of concrete encased conduit across East Main Street near Gerring Road

3. Other Business

COMMITTEE
Councillor Joseph Ciolino, Chair
Councillor Robert Whynot, Vice Chair
Councillor Greg Verga

Committee members – Please bring relevant documentation
Back-up and Supporting Documentation all on file at the City Clerk's Office, City Hall

CC: Mayor Kirk
Jim Duggan
Craig Spinale

10 APR 29 PM 12:34

CITY CLERK
GLOUCESTER, MA

PLANNING & DEVELOPMENT
May 5, 2010
DOCUMENTATION PREVIOUSLY ON FILE:

1. Unfinished Business:

- A) CC2010-016 (Verga) Request filed with City Clerk's Office on March 19, 2010 re: Lot on corner of Concord Street and Rt. 128

- B) COM2010-021: Request from Latitude 43 Restaurant & Fisherman's Wharf for temporary extension of use to utilize Lat 43/Fisherman's Wharf adjoining parking lot area for outside Fiesta Family Fish Fry

CITY CLERK
GLOUCESTER, MA
10 APR 22 PM 4: 58

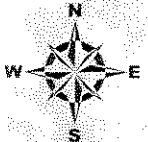

Assessors Map 234 Lot 38

Legend
Zoning Districts

- ResLotr20
- OldGI
- Oldr20
- BP - Busines Park
- CB - Central Business
- CCD - Civic Center District
- EB - Extensive Business
- GI - General Industrial
- MI - Marine Industrial
- NB - Neighborhood Business
- R-10 - Residential (10,000 sf)
- R-20 - Residential (20,000 sf)
- R-30 - Residential (30,000 sf)
- R-40 - Residential (40,000 sf)
- R-5 - Residential (5,000 sf)
- R-80 - Residential (80,000 sf)
- RC-40 - Coast Residential (40,000 sf)
- VB - Village Business

0 50 100 200 Feet



Former Zoning of 71 Concord Street

Dana Jorgensson

From: Linda Lowe [llowe@gloucester-ma.gov]
Sent: Tuesday, April 27, 2010 8:16 AM
To: 'Dana Jorgensson'
Cc: jsenos@ci.gloucester.ma.us
Subject: FW: Windover/Shorecliff

ok, that's what we'll do

*Linda Thomas Lowe
City Clerk
City of Gloucester
City Hall
Gloucester, MA. 01930 978 281 9720*

From: jackie hardy [mailto:jackieahardy@verizon.net]
Sent: Monday, April 26, 2010 5:36 PM
To: 'Miranda Gooding'; Linda Lowe
Cc: Councillor Steve Curcuru
Subject: Re: Windover/Shorecliff

Linda,
Since the matter, technically, is still before the P&D standing committee of the Council, please forward the letter to Chairman Ciolino at P&D with a copy of this extended email suggesting that P&D officially dispose of the matter so that they can report it out of committee back to Council as having been disposed of properly.
This follow through will be of assistance in years to come for anyone trying to track the status of the matter - this will show that there was a disposition of the matter.

Thank you,
Jackie Hardy

----- Original Message -----

From: Linda Lowe
To: 'Miranda Gooding'
Cc: 'jackie hardy'
Sent: Monday, April 26, 2010 3:46 PM
Subject: RE: Windover/Shorecliff

yes, that is how I understand it

*Linda Thomas Lowe
City Clerk
City of Gloucester
City Hall
Gloucester, MA. 01930 978 281 9720*

From: Miranda Gooding [mailto:mgooding@glovskyx2.com]
Sent: Monday, April 26, 2010 3:39 PM
To: Linda Lowe
Subject: RE: Windover/Shorecliff

Thank you Linda.

As a point of clarification, this means that Windover will not be able to pursue the 12-unit project that was approved as a major project by the Council. But they are not waiving or relinquishing any rights to the smaller project approved by the ZBA.

Thanks very much,

Miranda

From: Linda Lowe [mailto:llowe@gloucester-ma.gov]
Sent: Monday, April 26, 2010 3:09 PM
To: Miranda Gooding
Cc: 'jackie hardy'
Subject: RE: Windover/Shorecliff

Dear Attorney Gooding, thank you for the withdrawal of the request to extend the Feb. 14 2010 deadline for the Windover /Shorecliff SCP. I will see that it is filed and provided to the Council. I don't believe anything additional will be required however I have forwarded your email to Council President Jackie Hardy and I am assuming your client understands that Shorecliff project can now not go forward.

Linda Thomas Lowe
City Clerk
City of Gloucester
City Hall
Gloucester, MA. 01930 978 281 9720

From: Miranda Gooding [mailto:mgooding@glovskyx2.com]
Sent: Monday, April 26, 2010 2:09 PM
To: Linda Lowe - Clerk
Subject: Windover/Shorecliff

Dear Linda,

Attached please find a request to withdraw the pending extension request before the City Council. I trust this is all you need, but if you require any additional information, please don't hesitate to contact me. Thank you for your help,

Miranda

Miranda P. Gooding, Esq.
mgooding@glovskyx2.com

GLOVSKY & GLOVSKY LLC

4/27/2010

8 Washington Street
Beverly, MA 01915
Tel: 978.720.3122
Fax: 978.720.3181
www.glovskyandglovsky.com

This message and any attachments are intended only for the use of the intended recipient and may contain information that is PRIVILEGED and CONFIDENTIAL. If you are not the intended recipient, you are hereby notified that any dissemination of this communication is strictly prohibited. If you have received this communication in error, please delete all copies of this message and any attachments and notify us immediately. Thank you.

4/27/2010

nationalgrid

PP 2010-002

April 6, 2010

CITY CLERK
GLOUCESTER, MA
10 APR 12 AM 8:36

City Council
City Hall
Gloucester, MA 01930

Enclosed please find the following:

One (1) copy of Petition and two copies of Order for the installation of approximately 42' of 2-4" concrete encased conduit across East Main Street near Gerring Road, Gloucester, MA.

If granted, please retain your copy and return the others to this company.

Sincerely,

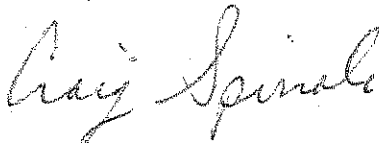

Craig Spinale
Supervisor Distribution Design

CS/mg

Enclosures

Petition of National Grid of 170 Medford Street, Malden, Massachusetts
for Electric Conduit Locations:

To the City Council – Gloucester, Massachusetts

Respectfully represents National Grid of Malden, Massachusetts, that it desires to construct a line of underground electric conduits, including the necessary sustaining and protecting fixtures, under and across the public way or ways hereinafter named.

Wherefore it prays that after due notice and hearing as provided by law, it may be granted permission to excavate the public highways and to run and maintain underground electric conduits, together with such sustaining and protecting fixtures as it may find necessary for the transmission of electricity. Said underground conduits to be located substantially in accordance with the plan filed herewith marked National Grid, UG-WR#8285513 03/20/10

The following are the streets and highways referred to:

EAST MAIN STREET – Installation of approximately 42' of 2-4" concrete encased conduit across East Main Street near Gerring Road.

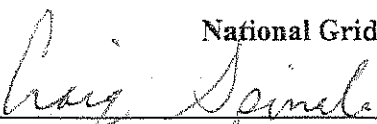
BY  **National Grid**
Craig Spinale-Supervisor Distribution Design

Dated this 6th day of April, 2010

April 6, 2010

By the City Council – Gloucester, Massachusetts

ORDERED:

Notice having been given and a public hearing held as provided by law, that National Grid be and it is hereby granted permission to excavate the public highways and to run and maintain underground electric conduits, together with such sustaining and protecting fixtures as said company may deem necessary, in the public way or ways hereinafter referred to, and to make the necessary house connections along said extensions, as requested in petition of said company dated the 6th day of April, 2010.

Said underground electric conduits shall be located substantially in accordance with the plan filed herewith marked National Grid, UG-WR#8285513 03/20/10.

The following are the public ways or parts of ways under which the underground electric conduits above referred to may be laid:

EAST MAIN STREET – Installation of approximately 42' of 2-4" concrete encased conduit
across East Main Street near Gerring Road.

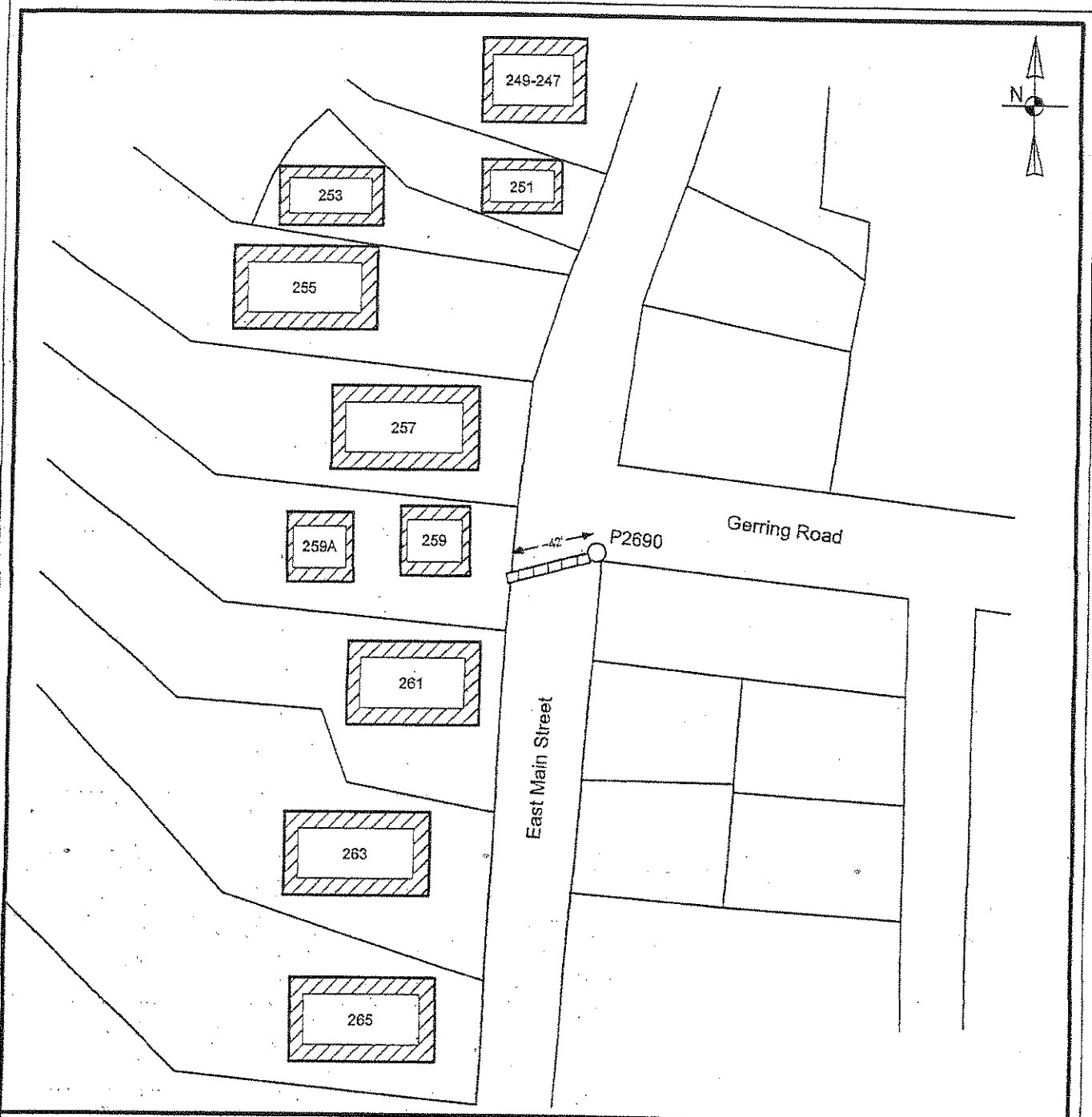

ELECTRIC DISTRIBUTION CONSTRUCTION PETITION

LEGEND

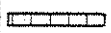

Proposed Conduit



Existing Wood Pole

nationalgrid

Malden, MA
WR #8285513

Date: 03/20/2010

Drawn By: R. Panos

To the City of Gloucester, MA

Sketch to Accompany Petition for:

The installation of approximately 42' of 2-4" concrete encased conduit across East Main Street near Gerring Road in the the city of Gloucester, MA 01930

DRAWING NOT TO SCALE. DISTACES ARE APPROXIMATE.

City of Gloucester, Abutters List

Report Description: MAP 80 LOT 29
Abutters To Parcel:

Please be aware that the abutters list reflects mailing addresses for the real estate tax bills as requested by the property owners. Mortgage companies, banks and other financial institutions may be receiving the notification and not the homeowner as required. Please be sure you are complying with notification requirements.
 Gloucester Board of Assessors

Abutter	Street Address	Parcel No.	Mailing Address
1 WHILTON BRUCE A & RUTH	247 EAST MAIN ST	79 12	C/O BRUCE A WHILTON 37 HIBISCUS DR PUNTA GORDA FL 33950
2 MONTAGNINO JAMES V JR	249 EAST MAIN ST	79 13	249 EAST MAIN ST GLOUCESTER MA 01930
3 BRADSHAW R BRUCE JOAN E TBYE	251 EAST MAIN ST	79 14	253 EAST MAIN ST GLOUCESTER MA 01930
4 BRADSHAW R BRUCE & JOAN E	253 EAST MAIN ST	79 15	253 EAST MAIN ST GLOUCESTER MA 01930-4141
5 GOLISANO SALVATORE TR	255 EAST MAIN ST	80 27	255 EAST MAIN ST GLOUCESTER MA 01930
6 BELL JANIS R	257 EAST MAIN ST	80 28	257 EAST MAIN ST GLOUCESTER MA 01930
7 BUTLER JOHN A & DOROTHY	259 EAST MAIN ST	80 29	259R EAST MAIN ST GLOUCESTER MA 01930
8 PHILLIPS MARTHA TR	261 EAST MAIN ST	80 30	3509 GARRISON ST SAN DIEGO CA 92106
9 STEIGER JOHN	265 EAST MAIN ST	80 31	265 EAST MAIN ST GLOUCESTER MA 01930
10 SIMMONDS THOMAS & LOIS	263 EAST MAIN ST	80 50	SIMMONDS THOMAS 263 EAST MAIN ST GLOUCESTER MA 01930 0000

3/17/10
Madonna Fleming

3/17/2010 2:19:39PM

BOARD OF ASSESSORS
 CITY HALL
 8 DALE AVENUE
 GLOUCESTER, MA 01930